



Bushley Close, Woodrow, Redditch B98 7TU

£130,000

3 1 1

- Three Bedrooms
- Bathroom & Guest WC
- Lounge
- Kitchen/Diner
- Conservatory
- Communal Parking
- Enclosed Rear Garden
- Popular Location



An ideal opportunity as an investment or for a first time buyer, a three bedroom mid terraced property offered with lounge, kitchen/diner, family bathroom and guest WC, conservatory, rear garden and communal parking. Situated in the popular location of Woodrow, Redditch.

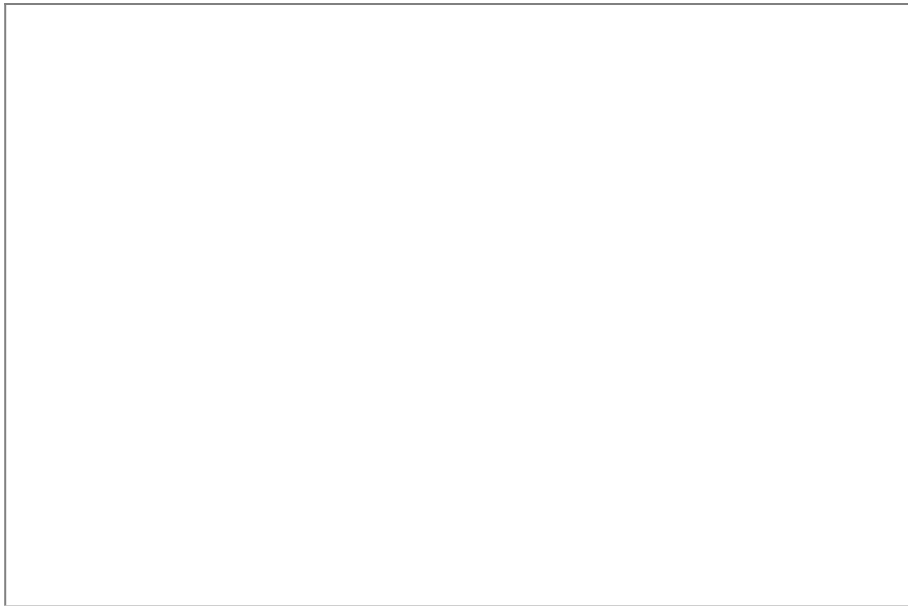
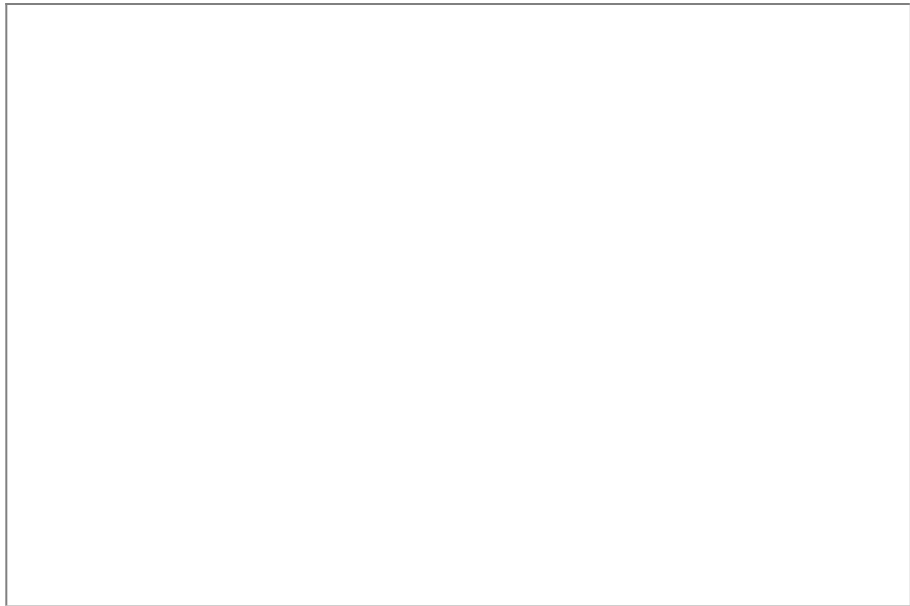
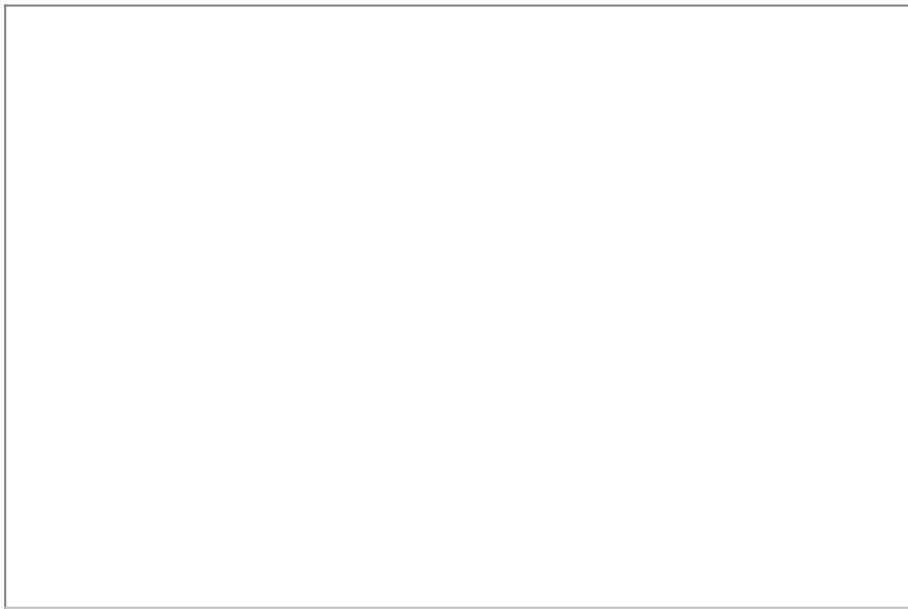

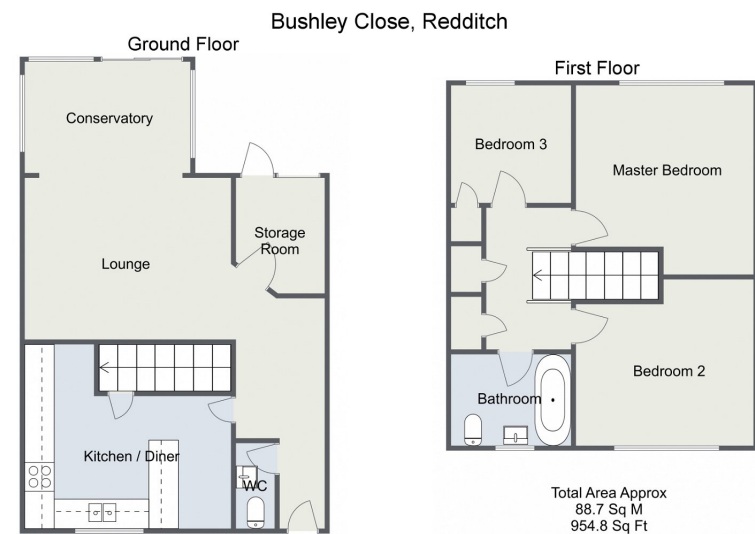
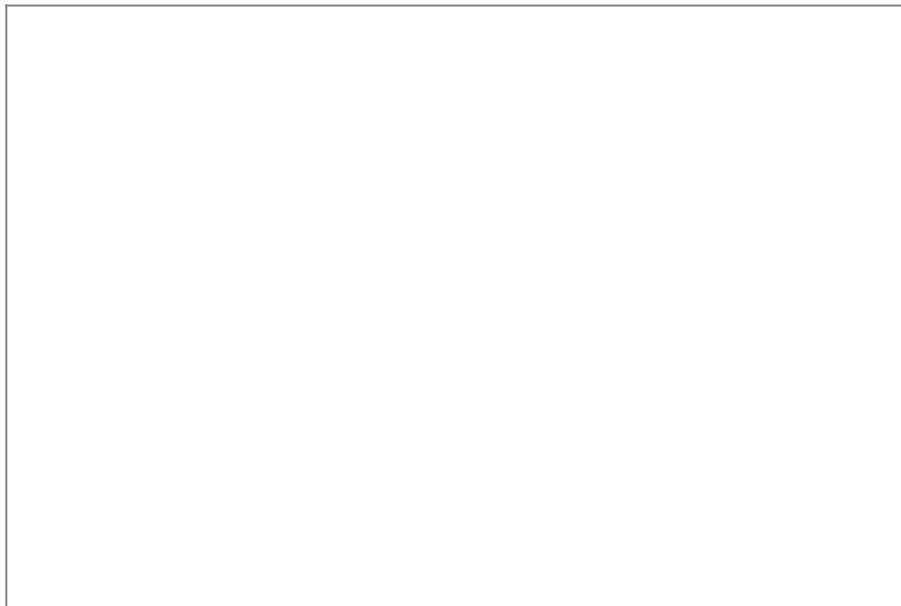

For illustrative purposes only. Decorative finishes, fixtures & fittings do not represent the current state of the property. Measurements are approximate & not to scale. Floor Plans made using RoomSketcher.

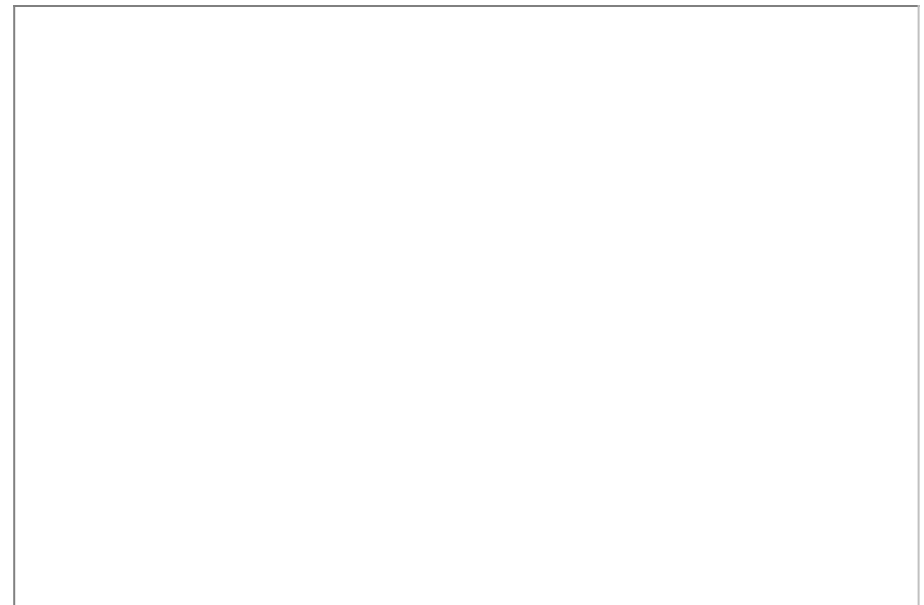
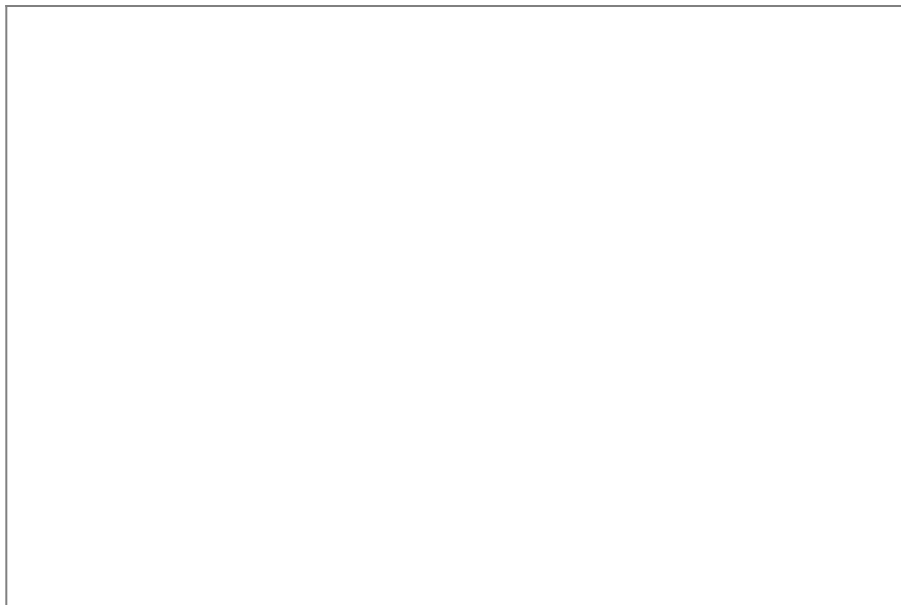

For more information on this house or to arrange a viewing please call the office on:

01527 540 654

Alternatively, you can scan the QR to view all of the details of this property online.



arden
ESTATE AGENTS